

THE MODERN HOUSE

## Westbourne Grove

LONDON W2

Approximate Floor Area = 46.6 sq m / 502 sq ft  
Outbuilding = 1.7 sq m / 19 sq ft  
Total = 48.4 sq m / 521 sq ft

Illustration for identification purposes only,  
measurements are approximate, not to scale

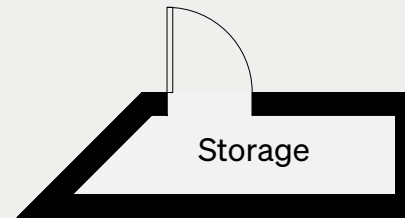
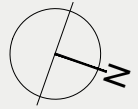

(Not Shown In Actual  
Location / Orientation)  
**OUTBUILDING**



**FIRST FLOOR**